

Product Dimensions

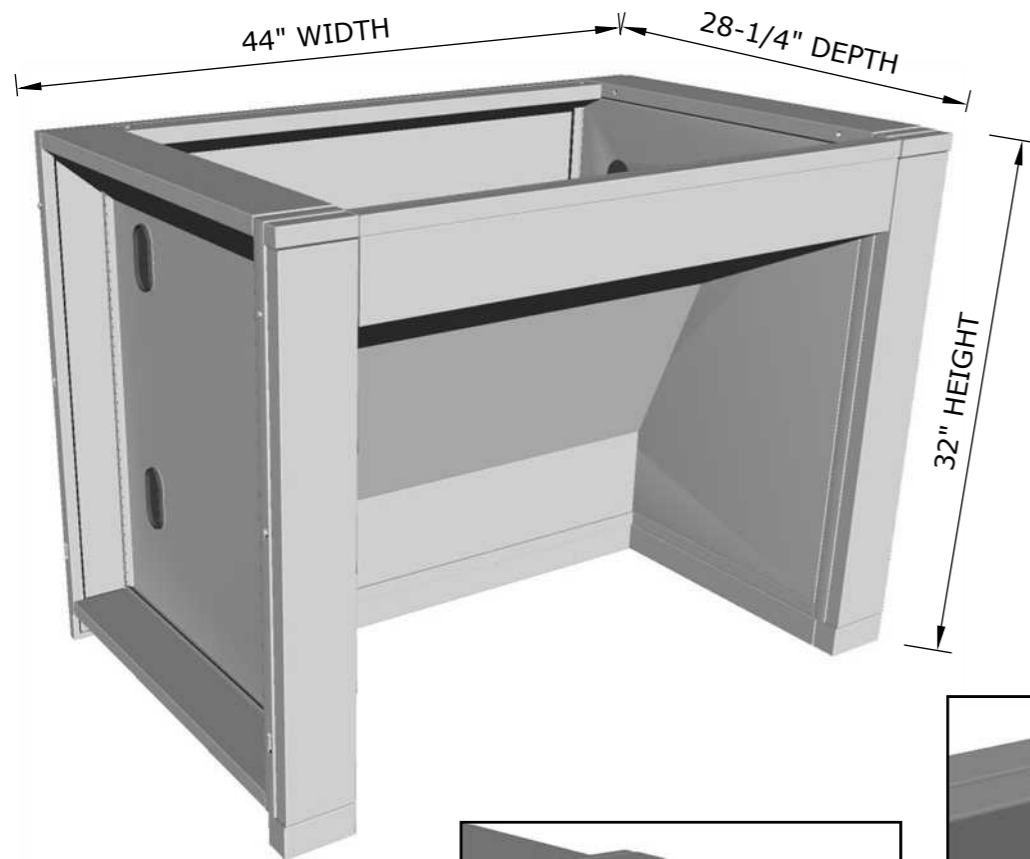

WHEN CENTER PANEL IS PLACED IN BACK POSITION, IN IT'S PLACE INSTALL THE TWO LEFT AND RIGHT SIDE HANDLES

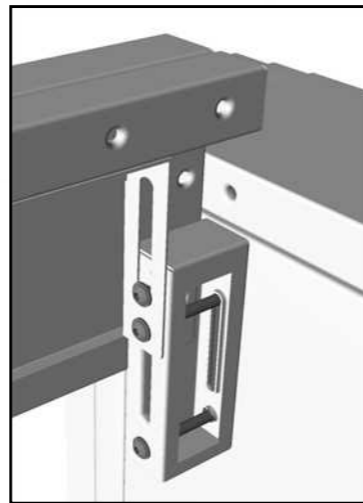
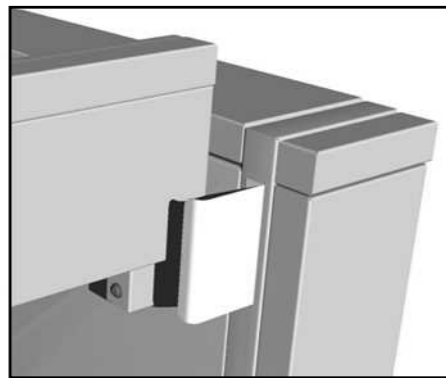

Cabinet Features

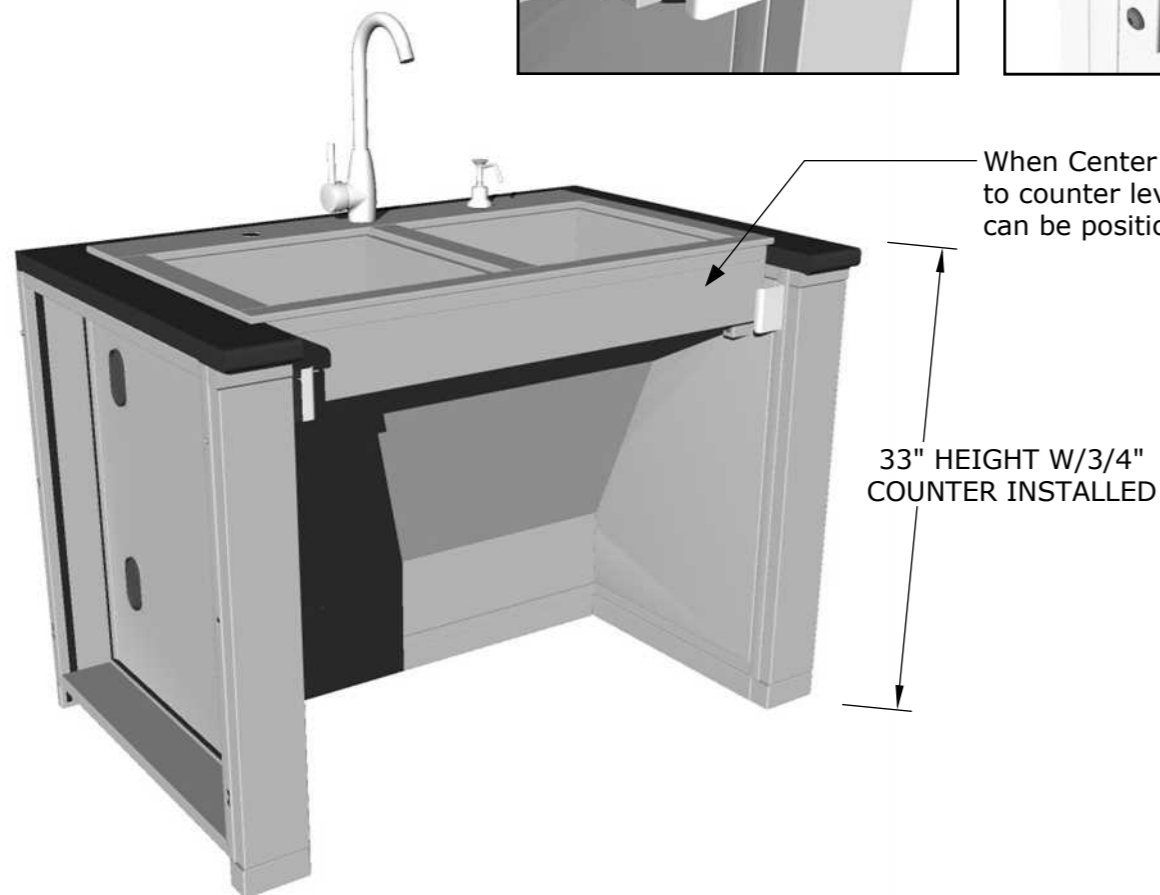

When Center Panel is raised to counter level 37" ADA Sink can be position right at front.

Center Panel can be placed in the Forward or Back Positions, by detaching the Left/Right bracket and re-positioning. When placed in the Back position, locate the Two Pull-Handles and install them in the Left/Right positions were Panel was installed in Forward Position. Center Panel can be lifted to meet counter level for ADA 37" Sink Installation.

1-GANG ELECTRICAL BOX LOCATION (NOT INCLUDED)

FLOOR ACCESS PANEL

FRONT PANEL CAN BE REMOVED BY LIFTING UP SLIGHTLY AND PULLING STRAIGHT OUT OF CABINET

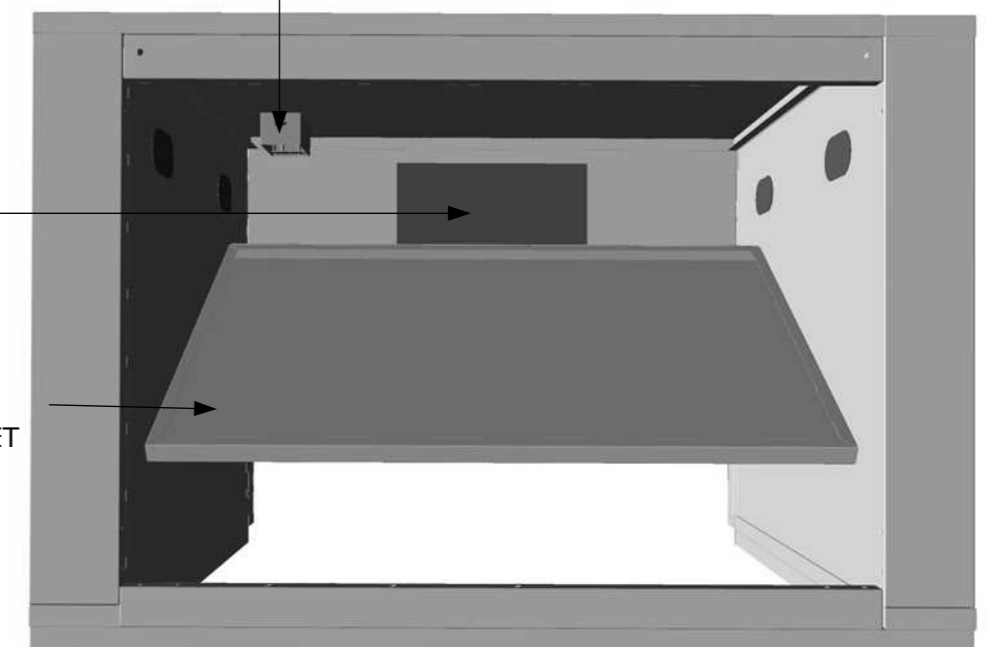

SUNSTONE METAL PRODUCTS
16004 CENTRAL COMMERCE DR.
PFLUGERVILLE, TEXAS 78660
Tel: 888.934.9449
Bus: 512.487.5116
Fax: 512.487.7016

PRODUCT

44" ADA Compliant Sink Base Cabinet w/ adjustable height and depth center panel

Item No. ADA44BC

DESCRIPTION

44" X 32" Height ADA Compliant Sink

- Lifetime Structure Warranty
- 304 Stainless Steel Structure
- 304 SS Rod Handles
- Pin-Lock & Screwed Installation
- Covered Access Ports

PRODUCT DIMENSIONS

44"W x 28-1/4"D
(w/Panel) x 32"H

MATERIAL SPECS

304 Stainless Steel entire structure, 18 Gauge for Door Panel, 18 Gauge for Cabinet Box, 18 Gauge for Shelf,

Interior Dimensions